

RESOLUTION # 2019-7-99

ESTABLISH AREA SERVICE "C" ROADS

WHEREAS, Linn County has received a request to classify a portion of Blodgett Road on the area service system to provide for a minimal level of maintenance and access by means of a gate; and

WHEREAS, the County Board of Supervisors, after consultation with the County Engineer, has the authority to specify roads within the County as Area Service "C" roads pursuant to Iowa Code Section 309.57; and

WHEREAS, the only persons who will have access rights to the road shall be:

- (1) the owner, lessee, or person in lawful possession of adjoining land,
- (2) The agent or employee of the owner, lessee or person in lawful possession of adjoining land,
- (3) any peace officer,
- (4) any magistrate,
- (5) any public employee whose duty it is to supervise the use or perform maintenance of the road,
- (6) any agent or employee of any utility located within the road right-of-way.

WHEREAS, the minimal level of maintenance will be as follows:

1. Blading. Blading or dragging will not be performed on a regular basis.
2. Snow and Ice Removal. Snow and ice will not be removed, nor will the road surface be sanded or salted on a regular basis.
3. Signing. Signing shall not be continued or provided. ALL AREA SERVICE LEVEL C ROADS SHALL BE IDENTIFIED WITH A SIGN AT POINTS OF ACCESS TO WARN THE PUBLIC OF THE LOWER LEVEL OF MAINTENANCE.
4. Weeds, Brush and Trees. Mowing or spraying weeds, cutting brush and tree removal will not be performed on a regular basis. Adequate sight distances will not be maintained.

Res # 2019-7-99

5. Structures. Bridges and culverts may not be maintained to carry legal loads. Upon failure or loss, the replacement structure will be appropriate for the traffic thereon.
6. Road Surfacing. There will be no surfacing materials applied to Area Service System C Roads on a regular basis.
7. Shoulders. Shoulders will not be maintained on a regular basis.
8. Crown. A crown will not be maintained on a regular basis.
9. Repairs. There will be no road repair on a regular basis.
10. Uniform Width. Uniform width for the traveled portion of the road will not be maintained.
11. Inspections. Regular inspections will not be conducted.

THEREFORE, BE IT RESOLVED BY THE BOARD OF SUPERVISORS OF LINN COUNTY that Linn County does hereby establish the road described as an Area Service "C" road, with restricted access and a minimal level of maintenance.

Blodgett Road beginning at the east right-of-way line of N Marion Road east 1/2 mile to near 100' west of NE corner of the SE1/4 of the SW1/4 of 30-86-6 (currently class B).

Resolution adopted this 3 day of July, 2019.

Linn County Board of Supervisors

  
\_\_\_\_\_  
Board of Supervisors Chairperson  
Vice

ATTEST:

  
Linn County Auditor  
Deputy

# Class C Reclassification

Blodgett Road  
North Marion Road east 1/2 mile

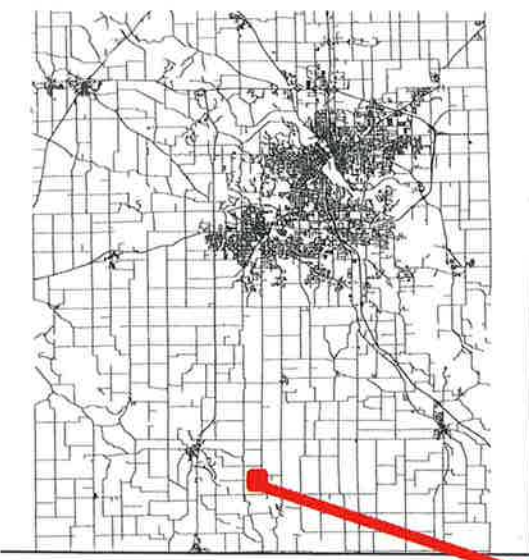

**PETITION TO RECLASSIFY ROAD TO CLASS C**

We, the undersigned property owners adjoining the county road described as Blodgett Road from North Marion Road east 1/2 mile

in section 30-86-6 and said road being known locally as Blodgett Road, respectfully petition the Linn County Board of Supervisors to reclassify the above described road, to Class C Classification.

Date	Signature	Address	Telephone
6/13/2019	<i>Deanne W. Long</i>	451 CR 276 Leander, Texas 78641	512-528-1775
6/13/2019	<i>Shawn M. Long</i>	451 CR 276 Leander, Texas 78641	512-528-1775

Roads may only be classified as area service "C" by ordinance or resolution upon petition signed by all landowners adjoining the road. The ordinance or resolution shall specify the level of maintenance effort and the persons who will have access rights to the road. The county shall only allow access to the road to the owner, lessee, or person in lawful possession of any adjoining land, or the agent or employee of the owner, lessee, or person in lawful possession, or to any peace officer, magistrate, or public employee whose duty it is to supervise the use or perform maintenance of the road. Access to the road shall be restricted by means of a gate or other barrier. The gate(s) and padlock(s) shall be provided and maintained by the landowner(s). The gate(s) and signs shall be installed by Linn County. The county and officers, agents, and employees of the county are not liable for injury to any person or for damage to any vehicle or equipment, or contents of any vehicle or equipment, which occurs proximately as a result of the maintenance of a road which is classified as area service "C"; if the road has been maintained to the level required for roads classified as area service "C";.



**PETITION TO RECLASSIFY ROAD TO CLASS C**

We, the undersigned property owners adjoining the county road described as Blodgett Road from North Marion Road east 1/2 mile

in section 30-86-6 and said road being known locally as Blodgett Road, respectfully petition the Linn County Board of Supervisors to reclassify the above described road, to Class C Classification.

Date	Signature	Address	Telephone
4/20/19	<i>Doug Kelly</i>	5031 W. Marion Rd	319 899 1054
6-17-2019	<i>Maria M. Anderson</i>	2307 BLODGETT ROAD CENTRAL CITY	319-438-6009

Roads may only be classified as area service "C" by ordinance or resolution upon petition signed by all landowners adjoining the road. The ordinance or resolution shall specify the level of maintenance effort and the persons who will have access rights to the road. The county shall only allow access to the road to the owner, lessee, or person in lawful possession of any adjoining land, or the agent or employee of the owner, lessee, or person in lawful possession, or to any peace officer, magistrate, or public employee whose duty it is to supervise the use or perform maintenance of the road. Access to the road shall be restricted by means of a gate or other barrier. The gate(s) and padlock(s) shall be provided and maintained by the landowner(s). The gate(s) and signs shall be installed by Linn County.

The county and officers, agents, and employees of the county are not liable for injury to any person or for damage to any vehicle or equipment, or contents of any vehicle or equipment, which occurs proximately as a result of the maintenance of a road which is classified as area service "C" if the road has been maintained to the level required for roads classified as area service "C".